

T 6 N — R 2 W. Salt Lake Meridian.

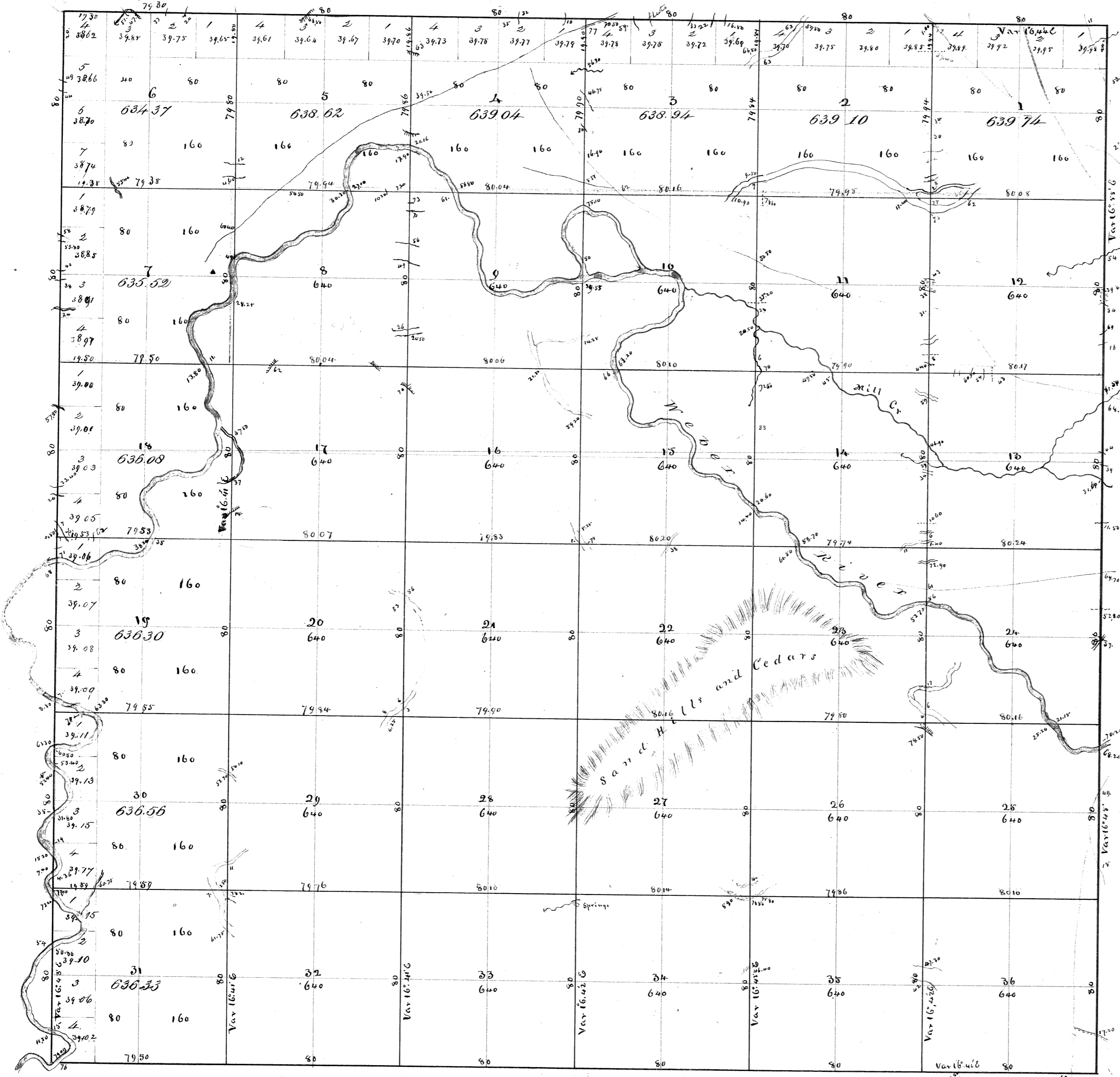

Notes
 N. Bdy. 35
 S. " 35
 E. " 14
 W. " 35
 Subs. 76
 Plat Books
 Exts.
 Subs. (2-76)

Scale 20 chains to an Inch

Total number of Acres 25,010.71

Survey designated	By whom surveyed	Date of Contract	Amount of Survey	When Surveyed
North Boundary	J. Brodowski	August 2, 1855	5, 79, 50	3rd quarter of 1855
West Boundary	do	do	0, 00, 00	do
Section lines	do	do	59, 77, 20	do

Surveyor General's Office
 Salt Lake City Dec 20 1855
 This Map of Township 6 North Range 2 West of Salt Lake Meridian is strictly conformable to the field notes of the survey thereof on file in this office which have been examined and approved
 David H. Burr
 Surveyor General of Utah