

15

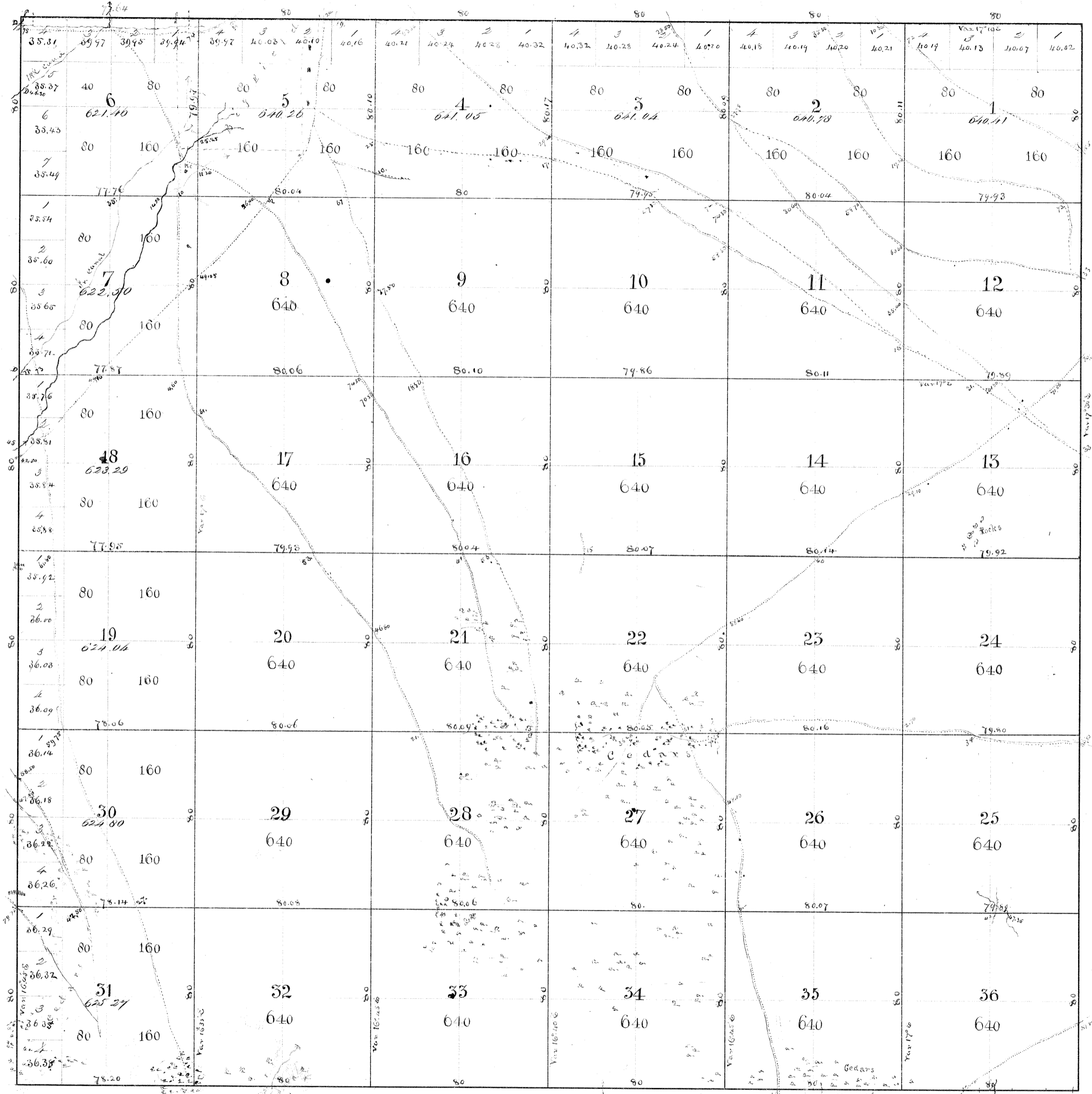

Notes  
N. Bdy. 57  
S. " 57-211  
E. " 14  
W. " 57  
Subs. 62  
Plat Books  
Exts.  
Subs. (4-15)

Total number of Acres. 22944.90

Scale 40 Chains to an Inch.

Survey designated	By whom surveyed	Date of contract	Amount of money	When Surveyed.
West Boundary	C. H. Craig	July 28 <sup>th</sup> 1856	6. 00. 00	2 <sup>nd</sup> 9 <sup>th</sup> 1856
North Boundary	do	do	5. 77. 64	do
Section lines	do	do	59. 70. 56	do

Surveyor General's Office  
Great Salt Lake City, Sept 8<sup>th</sup> 1856  
The above Map of Township 3 South of Range 5 West of Salt Lake Meridian is strictly conformable to the field notes of the survey thereof on file in this Office, which have been examined and approved.

David H. Burr

Surveyor General of Utah.

466